

PLOT 3

A **picturesque** three/four bedroom detached home built in **mellow brick**, with generous open plan living space and flexible accommodation, double garage and good sized garden.



PLOT 3



GROUND FLOOR

Living Room	5.11m x 3.36m	(16' 9" x 11' 0")
Kitchen/Dining/Family	7.79m x 3.37m max	(25' 6" x 11' 1" max)
Study/Playroom	2.16m x 2.12m	(7' 1" x 6' 11")
Cloakroom	2.12m x 0.98m	(6' 11" x 3' 2")
Double Garage		

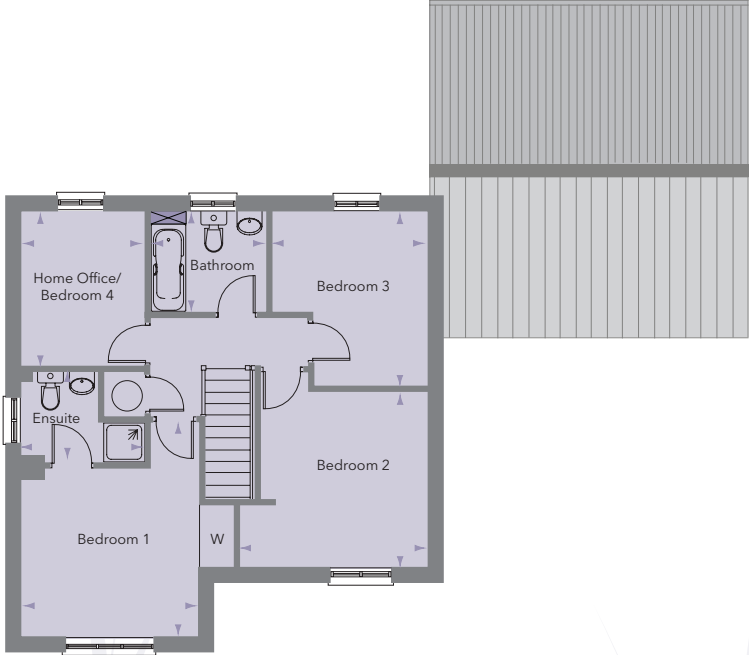

FIRST FLOOR

Bedroom 1	4.11m x 4.09m max	(13' 6" x 13' 5" max)
Ensuite	2.35m x 1.76m max	(7' 8" x 5' 9" max)
Bedroom 2	3.59m x 3.35m max	(11' 9" x 11' 0" max)
Bedroom 3	3.33m x 2.98m max	(10' 11" x 9' 9" max)
Home Office/Bedroom4	2.94m x 2.35m	(9' 8" x 7' 8")
Bathroom	2.22m x 1.90m	(7' 3" x 6' 3")