

Harburyfields

plots 33 and 34

A pair of delightful two bedroom semi-detached cottages. Plot 33 is constructed from Cotswold natural stone whilst plot 34 is brick built in Warwickshire Old English facing bricks with traditional dormer windows to the front.

A spacious living room, fully-fitted kitchen/dining room, cloakroom and convenient storage space make up the downstairs accommodation.

Upstairs the master bedroom benefits from an ensuite shower room, while the second bedroom has additional storage and is served by the family bathroom.

In addition both plots have a single garage.

Computer generated image

plots 33 and 34 first floor

Bedroom 1*
4.97m max x 3.12m (16'4" max x 10'3")

Ensuite shower room
1.91m x 1.61m max (6'3" x 5'3" max)

Bedroom 2*
4.03m x 2.94m (13'3" x 9'8")
plus built in store cupboard

Bathroom
2.94m max x 1.91m (9'8" max x 6'3")

*part reduced eaves to plot 34 only

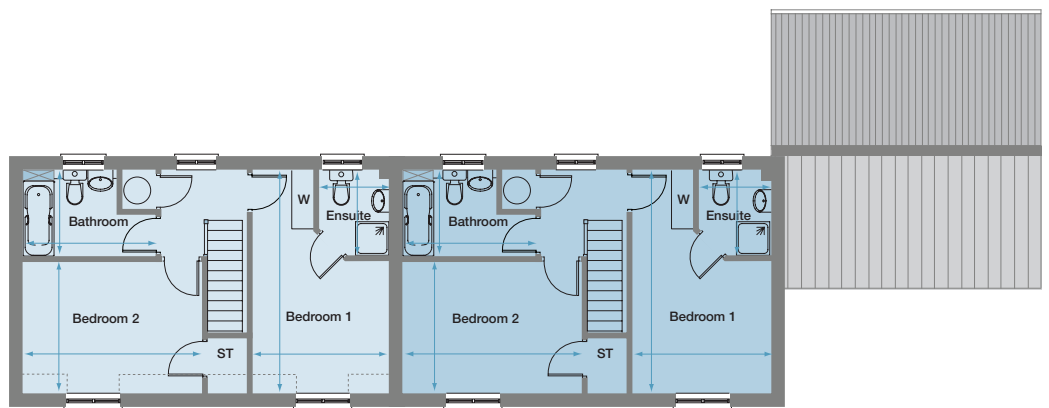

plots 33 and 34 ground floor

Living Room
4.97m x 3.12m (16'4" x 10'3")

Kitchen/Dining
4.97m x 2.94m (16'4" x 9'8")

Cloakroom
2.36m x 1.96m max (7'9" x 6'5" max)
including store cupboard

Single garage

