

Harburyfields

plot 45

Plot 45 is an imposing four bedroom detached home constructed in Warwickshire Old English brick. As a corner plot it benefits from additional gardens to the side as well as the rear.

This unique family home benefits from a living room with brick inglenook style feature fireplace and multi-fuel burning stove, separate dining room, study, a fully fitted kitchen/ breakfast room with separate utility room, cloakroom and a detached double garage.

The master bedroom has an ensuite shower room and fitted wardrobe, while the three further bedrooms are each of generous proportions.

A family bathroom completes the upstairs layout.

Computer generated image

plot 45 first floor

Bedroom 1
4.32m max x 3.91m (14'2" max x 12'10")

Ensuite shower room
2.17m x 2.06m max (7'2" x 6'9" max)

Bedroom 2
4.08m x 3.17m (13'5" x 10'5")

Bedroom 3
4.12m x 3.56m max (13'6" x 11'8" max)

Bedroom 4
3.89m x 3.35m max (12'9" x 11'0" max)

Bathroom
2.23m x 2.23m (7'4" x 7'4")

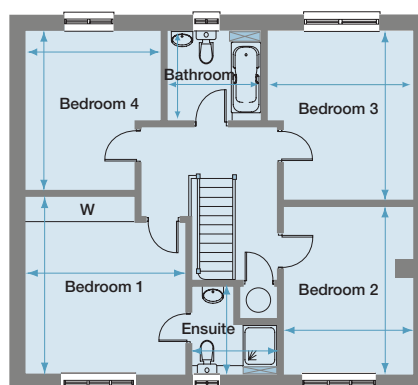

plot 45 ground floor

Living Room
5.15m x 4.20m (16'11" x 13'9")

Dining Room
4.20m x 3.04m (13'9" x 10'0")

Kitchen
5.05m x 3.67m (16'7" x 12'0")

Utility Room
2.01m x 1.64m (6'7" x 5'4")

Cloakroom
1.64m x 0.90m (5'4" x 3'0")

Study
2.81m x 2.77m (9'3" x 9'1")

Double garage

