

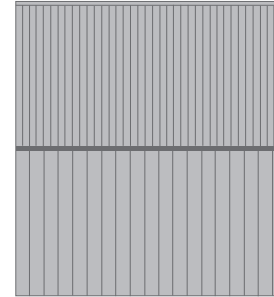

Plot 10 floorplans

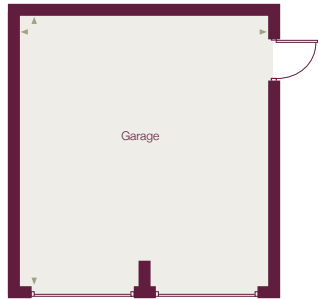

GROUND FLOOR

Kitchen/Dining		
Family	6.98m x 5.74m	(22'11" x 18'10")
Living Room	6.58m x 5.44m	(21'7" x 17'10")
Study	2.82m x 2.67m max	(9'3" x 8'9" max)
Utility	2.51m x 2.17m	(8'3" x 7'1")
Cloakroom	1.67m x 1.26m	(5'6" x 4'2")
Double Garage	6.00m x 5.50m	(19'8" x 18'1")

FIRST FLOOR

Bedroom 1	5.63m x 3.90m max	(18'6" x 12'10" max)
Dressing area	3.26m x 1.93m max	(10'8" x 6'4" max)
Ensuite	3.08m x 2.06m	(10'1" x 6'9")
Bedroom 2	5.17m x 5.23m max	(17'0" x 17'2" max)
Ensuite	2.16m x 1.58m	(7'1" x 5'2")
Bedroom 3	4.17m x 3.16m	(13'8" x 10'4")
Bedroom 4	3.37m x 3.13m	(11'1" x 10'3")
Bedroom 5	2.69m x 3.27m max	(8'10" x 10'9" max)
Bathroom	2.19m x 2.06m	(7'2" x 6'9")